

**PUBLIC INFORMATION BULLETIN NO. 37**  
**NOVEMBER - DECEMBER 2021**  
**AWA STREET WASTEWATER PUMP STATION**  
**FORCE MAIN AND SEWER SYSTEM IMPROVEMENTS**  
**WAIAKAMILO ROAD TRUNK SEWER**  
**JOB NO. W5-16**

### GENERAL INFORMATION

This bulletin is published to the project website ([www.awasewer.org](http://www.awasewer.org)) monthly to keep the community informed about construction work associated with the Awa Street Wastewater Pump Station Force Main and Sewer Improvements – Waiakamilo Road Trunk Sewer Project. The contract Notice-To-Proceed was issued to FV Coluccio Construction Company (FVCCC) on June 27, 2018. Heavy construction is scheduled to continue through the early portion of 2022. Please refer to the attached map and visit the project website for more detailed information about this project. To request hard copies of the monthly information bulletins please call the project hotline at (808) 219-7009.

### UPDATES FOR ONGOING ACTIVITIES

FVCCC performed the following work in October:

- Removal of inactive overhead utilities.
- Probing for underground obstructions.
- Construction of shafts.
- Installation of new sewer manholes.
- Finishing within new sewer manholes.
- Abandonment of inactive sewer lines and manholes
- Restoration of pavement and striping.
- Restoration of landscaped medians.

### NOVEMBER - DECEMBER FORECAST OF ACTIVITIES

The activities listed below are scheduled to continue or begin in November and/or December. The approximate locations and work hours for these activities are shown on the attached map.

- Probing for underground obstructions.
- Installation of new sewer lines by microtunneling.
- Restoration of pavement.

### TRAFFIC UPDATES FOR NOVEMBER – DECEMBER

Construction work will require relatively isolated lane closures at several locations on Waiakamilo Rd., Houghtailing St., Halona St., and/or School St. Access to driveways will be maintained via right turn motions from the travel lanes fronting them; however, access to some driveways via left turn motions may not be available due to the presence of work area closures.

Along Waiakamilo Rd., Houghtailing St, and School St. daytime and some early evening work is anticipated to occur.

Detours may be involved with work located within or near the intersection of School St. See below for associated traffic detours.

- **Traffic Detour for Work at N. School Street**  
**7:00 am to 3:30 pm, Monday through Friday**  
On Houghtailing St. in both the makai and mauka bound directions, through and/or left turn movements may be restricted.

On N. School St. in the Diamond Head bound direction, left turns may be restricted; while in the ewa bound direction, both left and right turns may be restricted.

In addition to these closures, the street segment of Houghtailing St. between N. School St. and Ahiahi St. may be closed and open to *LOCAL TRAFFIC AND THE BUS ONLY*.

Drivers affected by any of these work area closures will be detoured via Bernice St., Kapalama Ave., Hala Dr., and/or Aupuni St.

### CONTACT INFORMATION

For more information about this project, please visit the project website: [www.awasewer.org](http://www.awasewer.org) or call the project hotline at (808) 219-7009.

**CONSTRUCTION ACTIVITIES SCHEDULED FOR NOVEMBER - DECEMBER 2021**

54" PIPE INSTALLATION BY OPEN EXCAVATION

54" PIPE INSTALLATION BY MICROTUNNELING

42" PIPE INSTALLATION BY MICROTUNNELING

**INSTALLATION OF SEWER MANHOLES AND RESTORATION OF PAVEMENT (7:00 AM TO 3:30 PM, MONDAY THROUGH FRIDAY)**

**INSTALLATION OF NEW SEWERLINES BY MICROTUNNELING (7:00 AM TO 6:00 PM, MONDAY THROUGH SATURDAY)**

**RESTORATION OF MEDIAN LANDSCAPING (7:00 AM TO 3:30 PM, MONDAY THROUGH FRIDAY)**

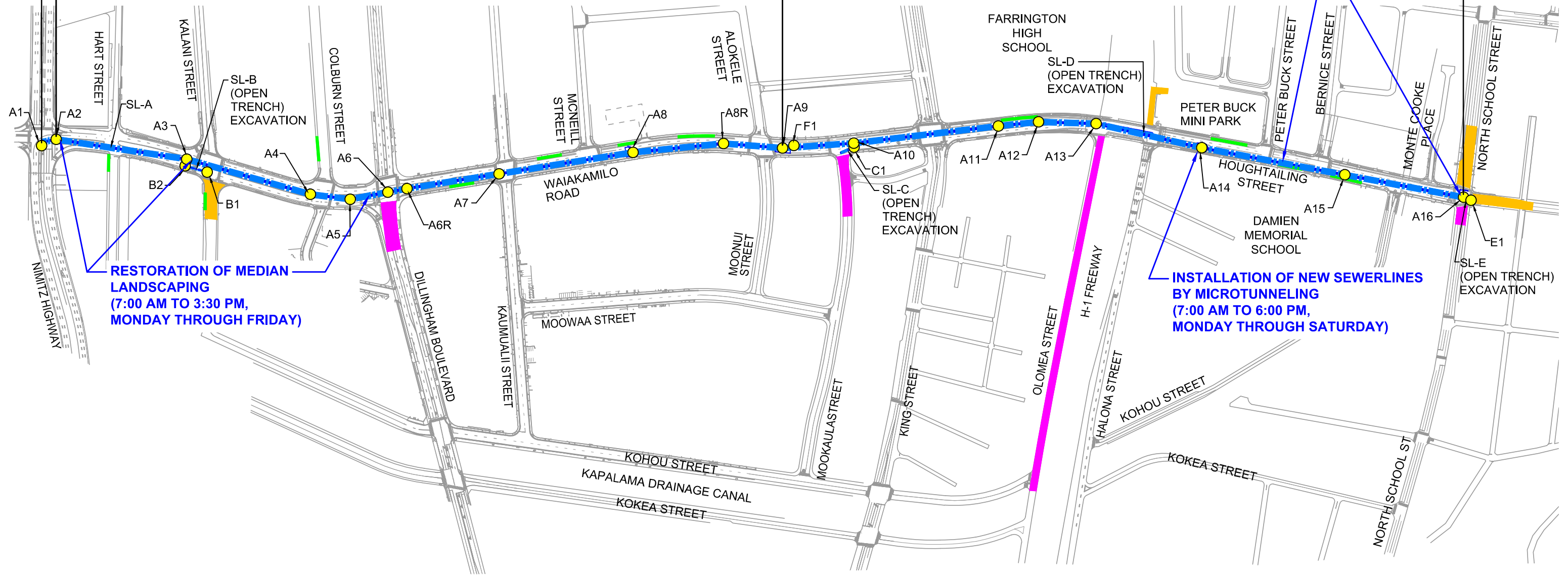

- LEGEND:
- NEW SEWER MANHOLE
  - ▬▬▬ NEW SEWER LINE
  - ▬▬▬ ABANDONED SEWER MANHOLE AND SEWER LINE WORK AREA
  - ▬▬▬ TEMPORARY EQUIPMENT STORAGE AREA
  - ▬▬▬ TEMPORARY BYPASS WORK AREA

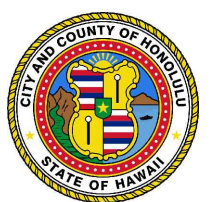

CITY AND COUNTY OF HONOLULU  
DEPARTMENT OF ENVIRONMENTAL SERVICES

**AWA STREET WASTEWATER PUMP STATION  
FORCE MAIN AND SEWER SYSTEM IMPROVEMENTS  
WAIAKAMILO ROAD TRUNK SEWER, C&C JOB NO. W5-16**