

**PUBLIC INFORMATION BULLETIN NO. 32**  
**JUNE - JULY 2021**  
**AWA STREET WASTEWATER PUMP STATION**  
**FORCE MAIN AND SEWER SYSTEM IMPROVEMENTS**  
**WAIAKAMILO ROAD TRUNK SEWER**  
**JOB NO. W5-16**

**GENERAL INFORMATION**

This bulletin is published to the project website ([www.awasewer.org](http://www.awasewer.org)) monthly to keep the community informed about construction work associated with the Awa Street Wastewater Pump Station Force Main and Sewer Improvements – Waiakamilo Road Trunk Sewer Project. The contract Notice-To-Proceed was issued to FV Coluccio Construction Company (FVCCC) on June 27, 2018. Heavy construction is scheduled to continue through the end of 2021. Please refer to the attached map and visit the project website for more detailed information about this project. To request hard copies of the monthly information bulletins please call the project hotline at (808) 219-7009.

**UPDATES FOR ONGOING ACTIVITIES**

FVCCC performed the following work in May:

- Installation of a sewer bypass.
- Pre-drilling and jet grouting for construction of microtunneling shafts.
- Construction of microtunneling and manhole installation shafts.
- Installation of new sewer lines by microtunneling.
- Installation of new sewer manholes.
- Finishing within new sewer manholes.

**JUNE/JULY FORECAST OF ACTIVITIES**

The activities listed below are scheduled to continue in June and/or July. The approximate locations and work hours for these activities are shown on the attached map.

- Installation of a sewer bypass.
- Construction of microtunneling and manhole installation shafts.
- Removal of underground obstructions.
- Installation of new sewer lines by microtunneling.
- Installation of new sewer lines by open trenching, including jet grouting and trench restoration.

- Installation of new sewer manholes.

**TRAFFIC UPDATES FOR JUNE/JULY**

Construction work will require relatively isolated lane closures at several locations on Waiakamilo Rd., Houghtailing St., Halona St., and/or School St. Access to driveways will be maintained via right turn motions from the travel lanes fronting them; however, access to some driveways via left turn motions may not be available due to the presence of work area closures.

Along Waiakamilo Rd., Houghtailing St, and School St. daytime and some early evening work is anticipated to occur.

Detours may be involved with work located within or near the intersection of School St. See below for associated traffic detours.

- **Traffic Detour for Work at N. School Street**  
**7:00 am to 5:30 pm, Monday through Saturday**  
On Houghtailing St. in both the makai and mauka bound directions, through and/or left turn movements may be restricted.

On N. School St. in the Diamond Head bound direction, left turns may be restricted; while in the ewa bound direction, both left and right turns may be restricted.

In addition to these closures, the street segment of Houghtailing St. between N. School St. and Ahiahi St. may be closed and open to *LOCAL TRAFFIC AND THE BUS ONLY*.

Drivers affected by any of these work area closures will be detoured via Bernice St., Kapalama Ave., Hala Dr., and/or Aupuni St.

**CONTACT INFORMATION**

For more information about this project, please visit the project website: [www.awasewer.org](http://www.awasewer.org) or call the project hotline at (808) 219-7009.

**CONSTRUCTION ACTIVITIES SCHEDULED  
FOR JUNE-JULY 2021**

54" PIPE  
INSTALLATION  
BY OPEN  
EXCAVATION

54" PIPE INSTALLATION BY MICROTUNNELING

42" PIPE INSTALLATION BY MICROTUNNELING

**INSTALLATION OF NEW MANHOLES  
AND RESTORATION OF SHAFTS  
(7:00 AM TO 5:30 PM,  
MONDAY THROUGH FRIDAY)**

**INSTALLATION OF A SEWER BYPASS AND  
CONSTRUCTION OF A SHAFT  
(7:00 AM TO 5:30 PM, MONDAY THROUGH SATURDAY)**

**JET GROUTING  
(7:00 AM TO 5:30 PM,  
MONDAY THROUGH SATURDAY)**

**INSTALLATION OF SEWER LINES BY  
MICROTUNNELING  
(7:00 AM TO 6:00 PM,  
MONDAY THROUGH SATURDAY)**

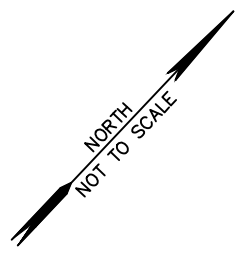
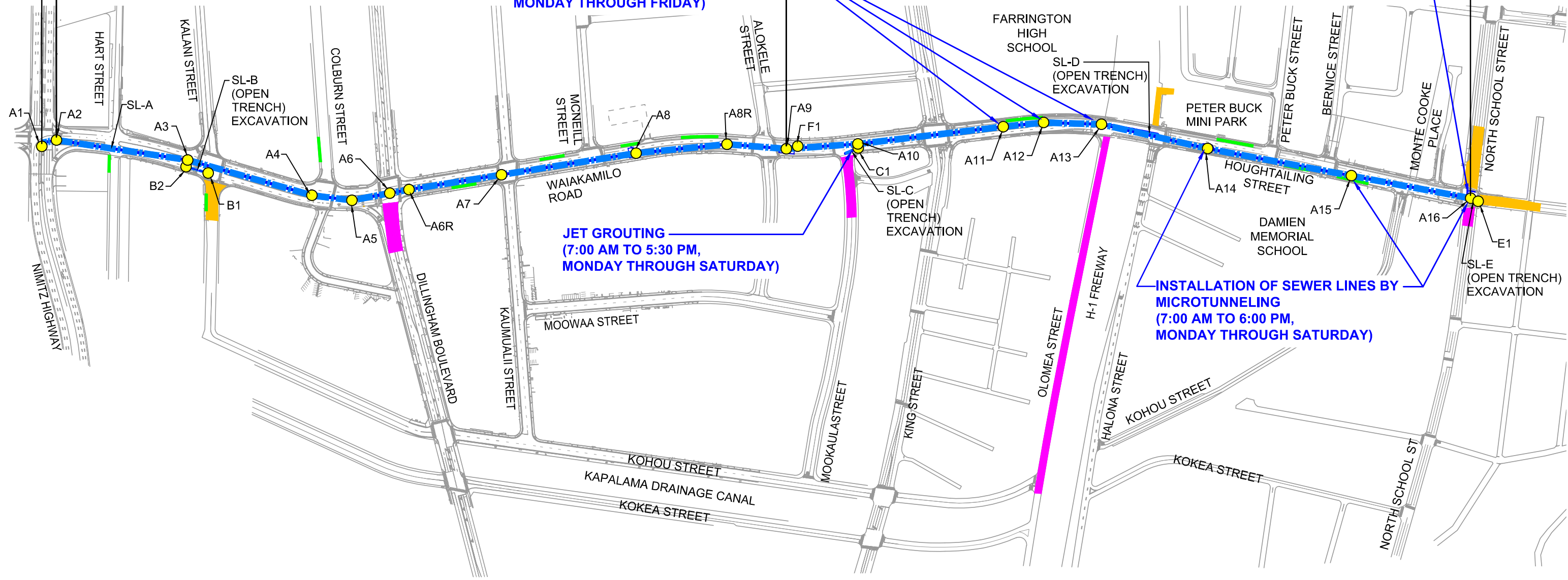

- LEGEND:**
- NEW SEWER MANHOLE
  - - - NEW SEWER LINE
  - ABANDONED SEWER MANHOLE AND SEWER LINE WORK AREA
  - TEMPORARY EQUIPMENT STORAGE AREA
  - TEMPORARY BYPASS WORK AREA

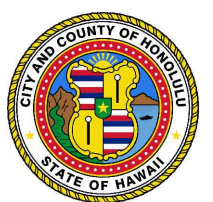

CITY AND COUNTY OF HONOLULU  
DEPARTMENT OF ENVIRONMENTAL SERVICES

**AWA STREET WASTEWATER PUMP STATION  
FORCE MAIN AND SEWER SYSTEM IMPROVEMENTS  
WAIAKAMILO ROAD TRUNK SEWER, C&C JOB NO. W5-16**