

PUBLIC INFORMATION BULLETIN NO. 18
MARCH 2020
AWA STREET WASTEWATER PUMP STATION
FORCE MAIN AND SEWER SYSTEM IMPROVEMENTS
WAIAKAMILO ROAD TRUNK SEWER
JOB NO. W5-16

GENERAL INFORMATION

This bulletin is published to the project website (www.awasewer.org) monthly to keep the community informed about construction work associated with the Awa Street Wastewater Pump Station Force Main and Sewer Improvements – Waiakamilo Road Trunk Sewer Project. The contract Notice-To-Proceed was issued to FV Coluccio Construction Company (FVCCC) on June 27, 2018. Heavy construction is scheduled to continue through the Summer of 2021. Please refer to the attached map and visit the project website for more detailed information about this project. To request hard copies of the monthly information bulletins please call the project hotline at (808) 219-7009.

UPDATES FOR ONGOING ACTIVITIES

FVCCC performed the following work in February:

- Relocation of underground utilities.
- Construction of a water line relocation shaft.
- Pre-drilling and jet grouting for construction of microtunneling shafts and pipe and manhole excavations.
- Construction of microtunneling and manhole installation shafts.
- Installation of new sewer lines by microtunneling.

MARCH FORECAST OF ACTIVITIES

The activities listed below are scheduled to continue and/or begin in March. The approximate locations and work hours for these activities are shown on the attached map.

- Construction of a water line relocation shaft.
- Pre-drilling and jet grouting for construction of microtunneling shafts and pipe and manhole excavations.
- Construction of microtunneling and manhole installation shafts.
- Installation of new sewer lines by microtunneling.

TRAFFIC UPDATES FOR MARCH

Construction work will require relatively isolated lane closures at several locations on Waiakamilo Rd., Houghtailing St., Dillingham Blvd., and/or Nimitz Hwy. Access to driveways will be maintained via right turn motions from the travel lanes fronting them; however, access to some driveways via left turn motions may not be available due to the presence of work area closures.

Along Waiakamilo Rd., continuous daytime and nighttime work is anticipated to occur. On Nimitz Hwy., near the intersection with Waiakamilo Rd., work is anticipated to occur on weeknights and all day on the weekends.

Detours may be involved with work located within or near the intersections of Nimitz Hwy. and Dillingham Blvd. See below for associated traffic detours.

- **Traffic Detour for Work near Nimitz Hwy.**
6:00 pm to 2:00 am (Monday through Friday) and
Continuously from 6:00 pm Friday to 2:00 am Monday
Through and left turn movements out of Piers 39 and 40 towards Waiakamilo Rd. and Nimitz Hwy. may be prohibited and detoured via right turn and U-turn on Nimitz Hwy.

Left turn movements towards Nimitz Hwy. eastbound and through movements to Piers 39 and 40 from Waiakamilo Rd. will be prohibited and detoured via Kalani St. and Kalihi St.

Left turn movements from Nimitz Hwy. towards Waiakamilo Rd. and Piers 39 and 40 will be prohibited and detoured via U-turns on Nimitz Hwy near Pier 38 and Libby Street, respectively.

- **Traffic Detour for Work at Dillingham Blvd.**

**7:00 pm to 5:00 am (Monday through Friday) and
Continuously from 7:00 pm Friday, March 6 to
5:00 am Monday, March 9**

All left turn movements and some through movements at the Dillingham Blvd. and Waiakamilo Rd. intersection will be prohibited.

Drivers affected by this closure will be detoured via Kohou St., Kaumualii St., McNeill St., and/or Kalani St.

CONTACT INFORMATION

For more information about this project, please visit the project website: www.awasewer.org or call the project hotline at (808) 219-7009.

CONSTRUCTION ACTIVITIES SCHEDULED FOR MARCH 2020

54" PIPE
INSTALLATION
BY OPEN
EXCAVATION

54" PIPE INSTALLATION BY MICROTUNNELING

42" PIPE INSTALLATION BY MICROTUNNELING

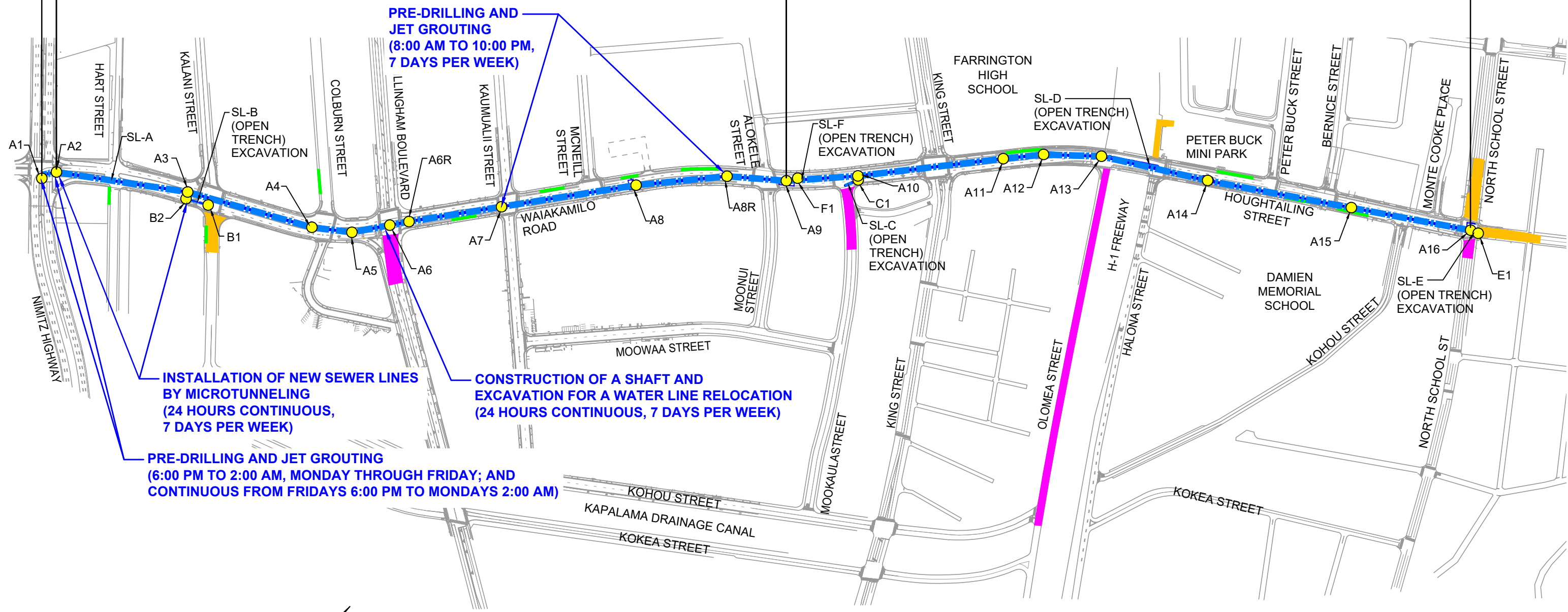

PRE-DRILLING AND JET GROUTING
(8:00 AM TO 10:00 PM,
7 DAYS PER WEEK)

**INSTALLATION OF NEW SEWER LINES
BY MICROTUNNELING**
(24 HOURS CONTINUOUS,
7 DAYS PER WEEK)

PRE-DRILLING AND JET GROUTING
(6:00 PM TO 2:00 AM, MONDAY THROUGH FRIDAY; AND
CONTINUOUS FROM FRIDAYS 6:00 PM TO MONDAYS 2:00 AM)

**CONSTRUCTION OF A SHAFT AND
EXCAVATION FOR A WATER LINE RELOCATION**
(24 HOURS CONTINUOUS, 7 DAYS PER WEEK)

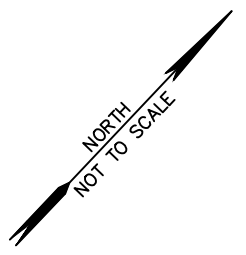

- LEGEND:**
- NEW SEWER MANHOLE
 - NEW SEWER LINE
 - ABANDONED SEWER MANHOLE AND SEWER LINE WORK AREA
 - TEMPORARY EQUIPMENT STORAGE AREA
 - TEMPORARY BYPASS WORK AREA

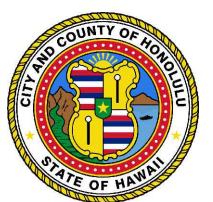

CITY AND COUNTY OF HONOLULU
DEPARTMENT OF ENVIRONMENTAL SERVICES

**AWA STREET WASTEWATER PUMP STATION
FORCE MAIN AND SEWER SYSTEM IMPROVEMENTS
WAIAKAMILO ROAD TRUNK SEWER, C&C JOB NO. W5-16**